

PRELIMINARY FOREST MANAGEMENT MAP
for the lands of the
Town of Dorset - "Gettysburg Quarry Parcel"
Dorset, Vermont

Locus Map

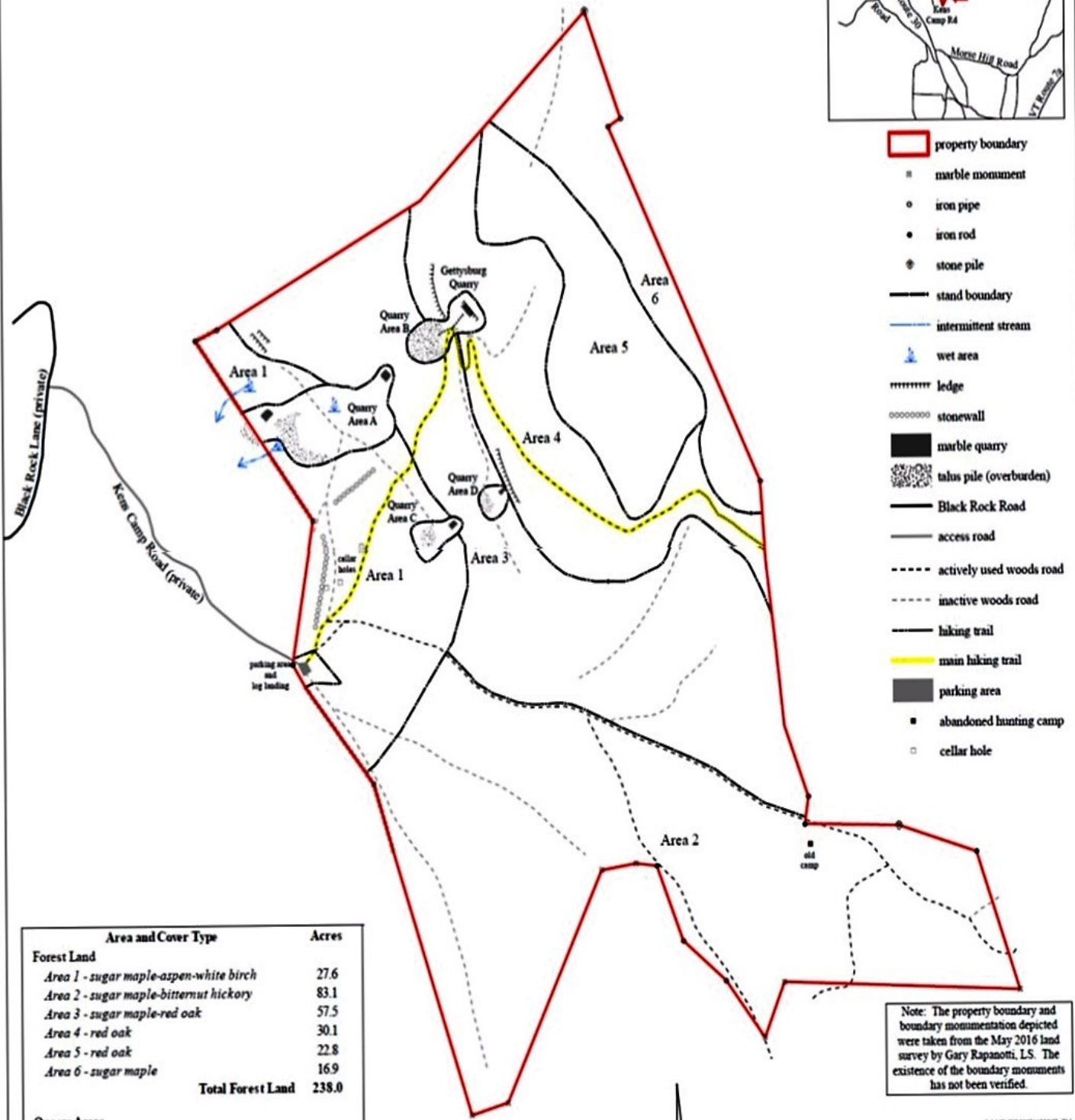

- property boundary
- marble monument
- iron pipe
- iron rod
- ⊕ stone pile
- stand boundary
- intermittent stream
- wet area
- ledge
- stonewall
- marble quarry
- talus pile (overburden)
- Black Rock Road
- access road
- - - - - actively used woods road
- - - - - inactive woods road
- hiking trail
- main hiking trail
- parking area
- abandoned hunting camp
- cellar hole



Area and Cover Type	Acres
Forest Land	
Area 1 - sugar maple-aspens-white birch	27.6
Area 2 - sugar maple-bitternut hickory	83.1
Area 3 - sugar maple-red oak	57.5
Area 4 - red oak	30.1
Area 5 - red oak	22.8
Area 6 - sugar maple	16.9
Total Forest Land	238.0
Quarry Areas	
Quarry A - Lower and Middle Prince Quarries	5.6
Quarry B - Gettysburg Quarry (Upper Prince)	1.7
Quarry C	0.8
Quarry D - Klondike Quarry	0.5
Total Quarry Land	8.6
parking area and log landing	0.6
Total Parcel	247.2

Note: The property boundary and boundary monumentation depicted were taken from the May 2016 land survey by Gary Rapanotti, L.S. The existence of the boundary monuments has not been verified.



1:5,000

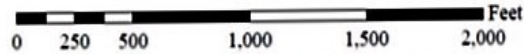

This is not a survey - boundaries are approximate.

MAP PRODUCED BY

Calfee Woodland Management I.J.C.
Dorset, Vermont
802-231-2555
14 September 2016